

**DIN 914 / A2**

**Viti senza testa con cava esagonale e punta conica**

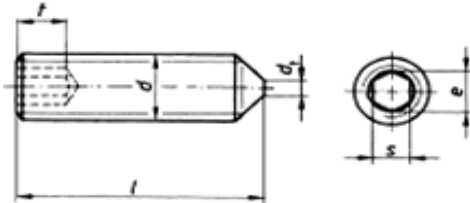

ISO 4027

d	M 2	M 2,5	M 3	M 4	M 5	M 6
l / mm						
3	●	●	●			
4	●	●	●	●		
5	●	●	●	●	●	●
6	●	●	●	●	●	●
8	●	●	●	●	●	●
10	●	●	●	●	●	●
12	●	●	●	●	●	●
14					●	●
16	●	●	●	●	●	●
20			●	●	●	●
25			●	●	●	●
30			●	●	●	●
35					●	●
40					●	●
45					●	●
50					●	●
60						●
<b>CONFEZIONE</b>	<b>500</b>	<b>500</b>	<b>500</b> ≤ 30 <b>200</b> >30	<b>500</b> ≤ 30 <b>200</b> >30	<b>500</b> ≤ 25 <b>200</b> >25	<b>200</b>
<i>dt max</i>	-	-	-	-	-	1,5
<i>t min</i>	0,8	1,2	1,2	1,5	2	2
<i>e min</i>	1,003	1,427	1,73	2,3	2,87	3,44
<i>s</i>	0,9	1,3	1,5	2	2,5	3

**DIN 914 / A2**

**Viti senza testa con cava esagonale e punta conica**

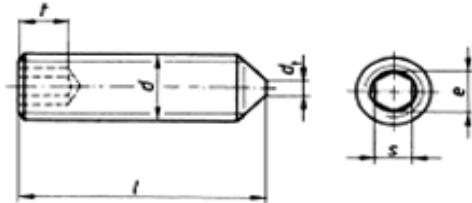

ISO 4027

d	M 8	M 10	M 12	M 16	M 20
l / mm					
6	●				
8	●				
10	●	●			
12	●	●	●		
16	●	●	●	●	
20	●	●	●	●	●
25	●	●	●	●	●
30	●	●	●	●	●
35	●	●	●	●	●
40	●	●	●	●	●
45	●	●	●	●	●
50	●	●	●	●	●
55			●		
60	●	●	●	●	●
70			●	●	●
80			●	●	
90			●	●	
100				●	
<b>CONFEZIONE</b>	<b>200</b>	<b>200</b>	<b>100</b>	<b>50</b>	<b>50</b>
		≤ 25	≤ 70	≤ 80	≤ 70
		100	50	25	25
		>25	>70	>80	>70
<i>dt max</i>	2	2,5	3	4	5
<i>t min</i>	3	4	4,5	6,4	8
<i>e min</i>	4,58	5,72	6,86	9,15	11,43
<i>s</i>	4	5	6	8	10